

CFC

1

High-density rectangular board series electrical connector

Description of products

This series of electrical connector products, using 1.30mm grid spacing, in line with the technical requirements of the specification Q/3E20032-2006 (equivalent to the Russian military specification, with a small size, high density contact parts, at the end of the cable can be lined up with the cable for point-to-point welding, PCB dip soldering, applied to the AC and DC circuits, as well as impulse circuits, have the function of preventing wrong insertion.

The contacts of this series are made of stranded elastic pins (twisted pins) with reliable contact, soft insertion and can be interchanged with Russian PPC1-M series products. This series of electrical connectors are widely used in aviation and aerospace vehicles as well as electrical equipment electrical connections.

PERFORMAN CE

temperature : -60°C~+85°C
 vibration : 1Hz~2500Hz 392m / s²
 acceleration : 14700m / s² -1470m/s²
 impact : 980m/s²
 Humidity : 35°C--98%
 contact resistance : <0.01Ω
 electrical insulation resistance:normal : ≥1000MΩ,wet: ≥ 20MΩ
 rated current : 1A, single contact max working 2A
 operating voltage : 150V
 withstand voltage : 600V 1min
 mechanical life : 250 times
 working life : ≥ 90000h



Product

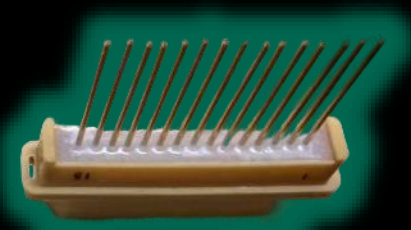

Sample

Tag Description

Main code	CFC	1	-15	T	J
Series					
contact number					
Electrical Connector Type					
T-Plug	Z-socket				
Contact plating	Gold	J	Silver	Y	

CFC1

High-density rectangular electrical connector series

Insulator contact arrangement (pin insulator insertion surface)

code name	
CFC	РПС
1	1-M
contacts 7, 15, 21, 37	7, 15, 21, 37
plug T	Ш
socket Z	Г
gold J	
silver Y	С

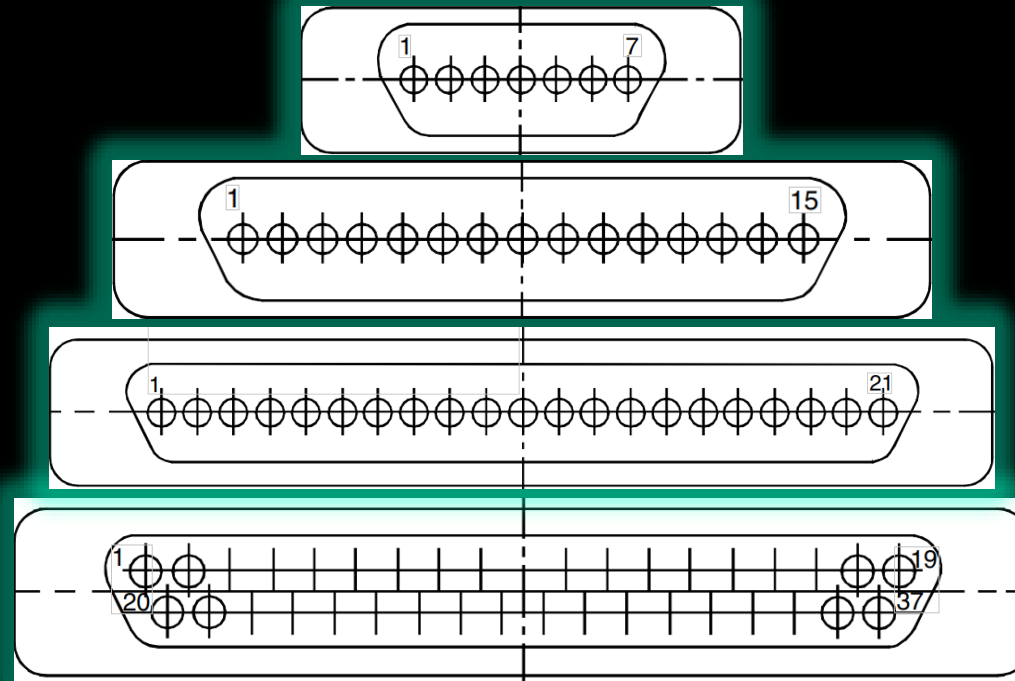

CFC1

series of rectangular connectors

Size
7,15,21

7,15,21,37 contacts plug

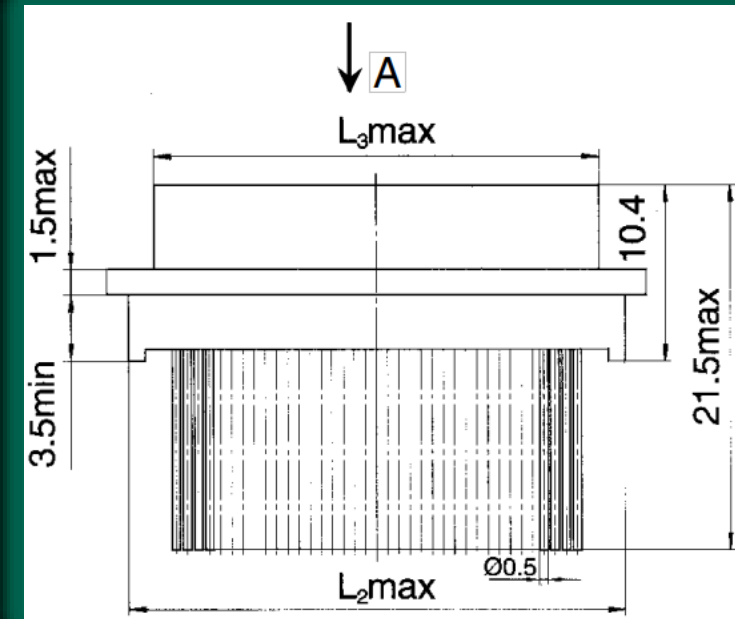
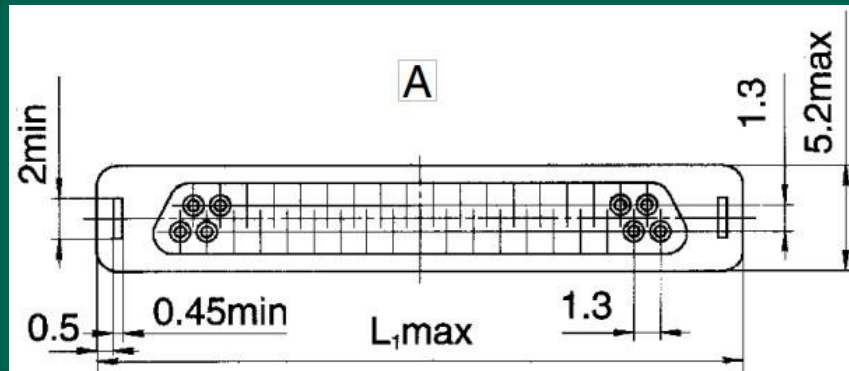
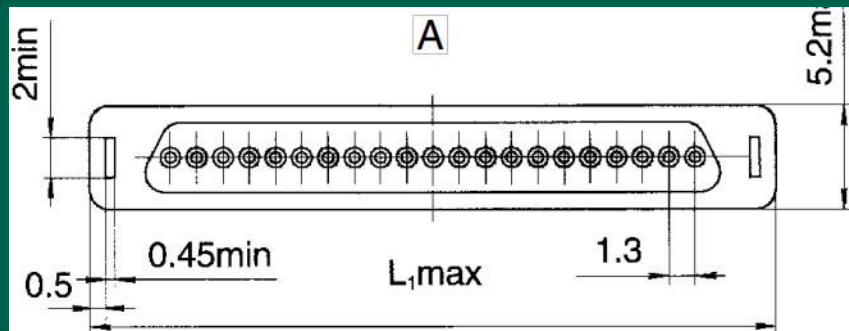

number of contacts	L_1 max,mm	L_2 max,mm	L_3 max,mm
7	16	13.5	10.5
15	26.5	24	21
21	34	31.5	28.5
37	31.5	29	26

CFC1

series of rectangular connector

7,15,21,37 contacts socket

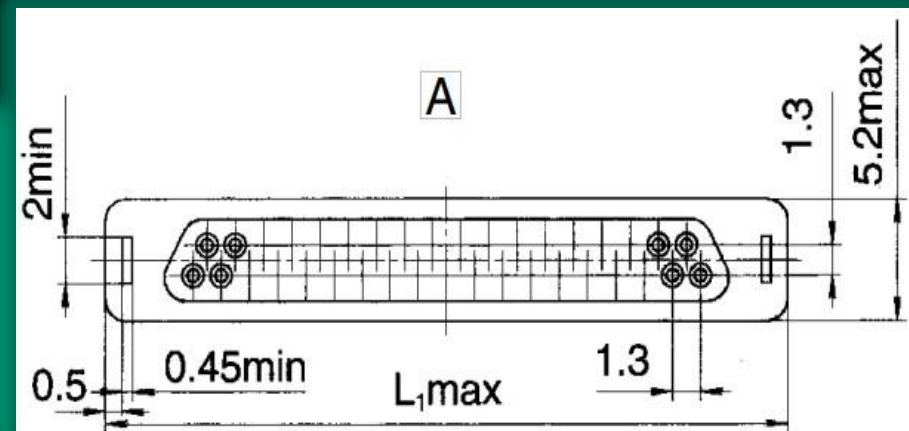
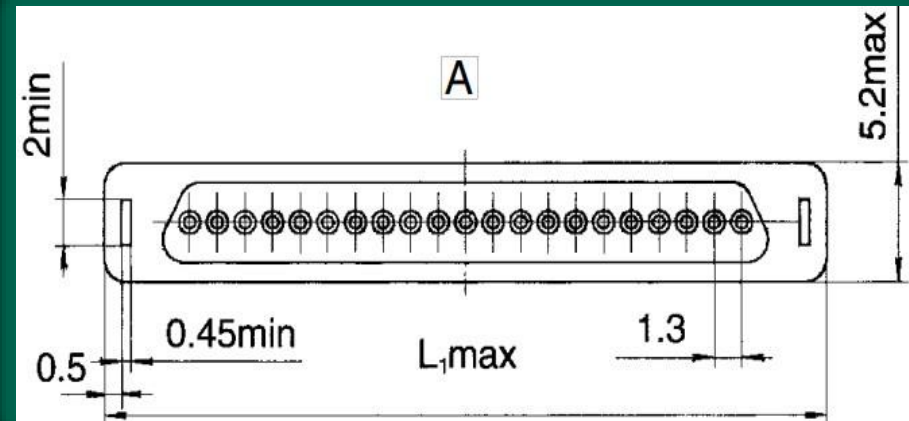
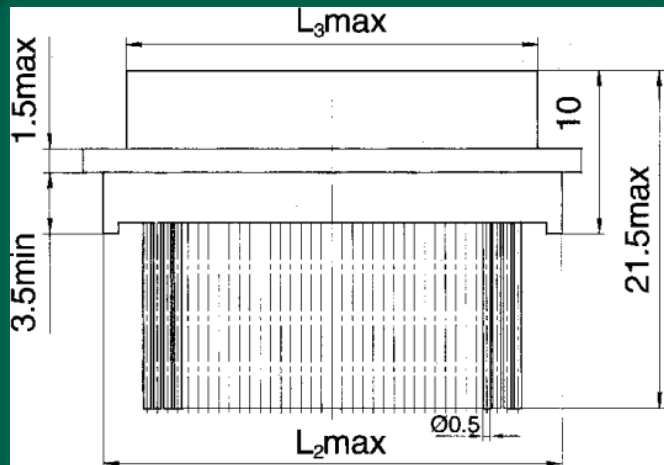

number of contacts	L_1 max,mm	L_2 max,mm	L_3 max,mm
7	16	13.5	12.2
15	26.5	24	22.7
21	34	31.5	30.2
37	31.5	29	27.80